



a Geberit company

2100 South Clearwater Drive
Des Plaines, IL 60018
Phone: 847-803-5000
Fax: 847-803-5454
www.chicagofaucets.com

REPAIR PARTS

BY: SID DATE: 09-19-13

CHK: *[Signature]* REV:

FITTING NO.

860-ABCP

SUBMITTED MODEL NO.

ITEM NO.

FOR TECHNICAL ASSISTANCE
1-800-TEC-TRUE (1-800-832-8783)

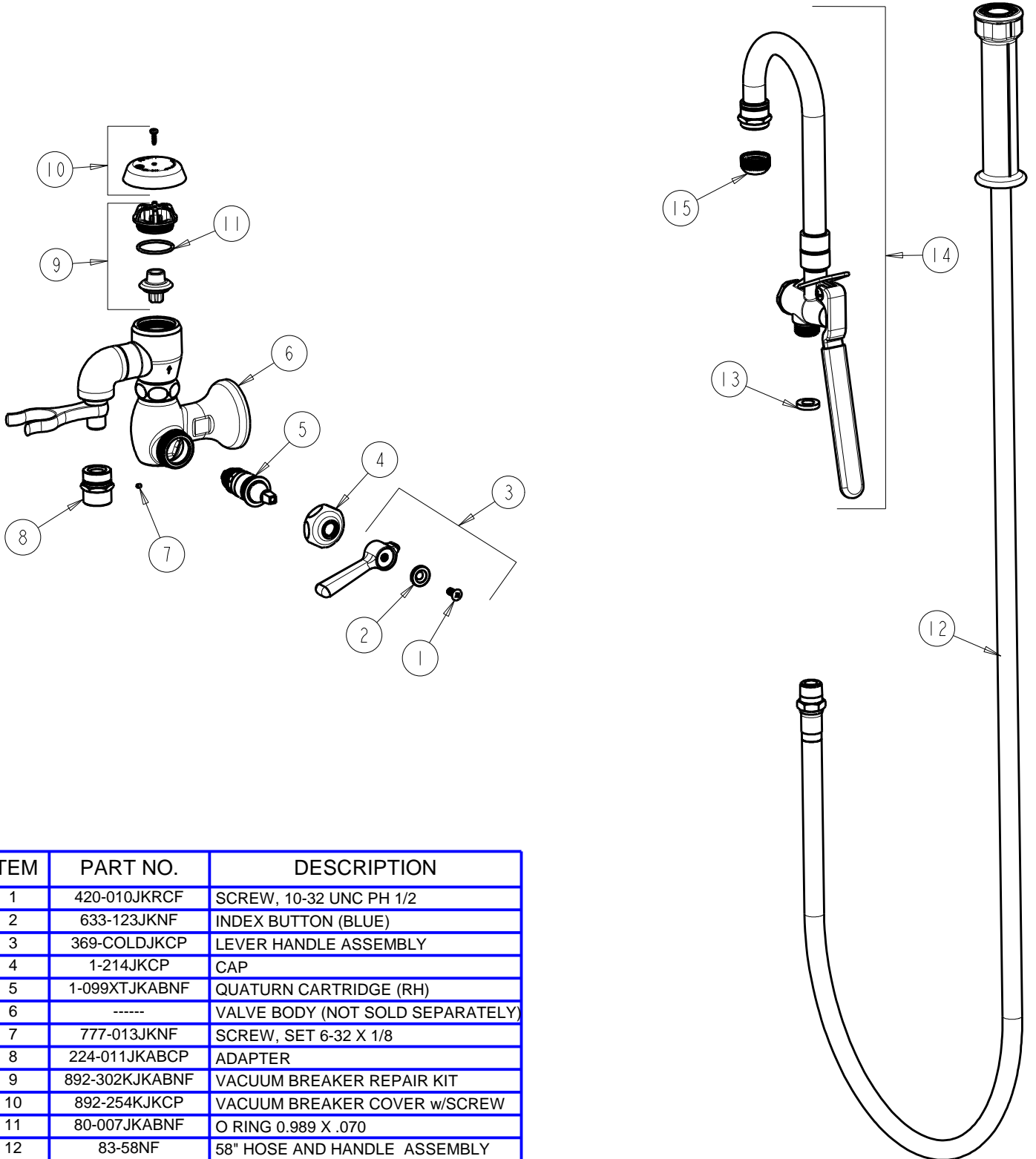

ITEM	PART NO.	DESCRIPTION
1	420-010JKRCF	SCREW, 10-32 UNC PH 1/2
2	633-123JKNF	INDEX BUTTON (BLUE)
3	369-COLDJKCP	LEVER HANDLE ASSEMBLY
4	1-214JKCP	CAP
5	1-099XTJKABNF	QUATURN CARTRIDGE (RH)
6	-----	VALVE BODY (NOT SOLD SEPARATELY)
7	777-013JKNF	SCREW, SET 6-32 X 1/8
8	224-011JKABCP	ADAPTER
9	892-302KJKABNF	VACUUM BREAKER REPAIR KIT
10	892-254KJKCP	VACUUM BREAKER COVER w/SCREW
11	80-007JKABNF	O RING 0.989 X .070
12	83-58NF	58" HOSE AND HANDLE ASSEMBLY
13	919-243JKNF	GASKET, .685 X .375 X .125
14	90-GNABCP	PRE-RINSE KETTLE FILLER VALVE
15	E1JKABRCF	PLAIN OUTLET WITH SCREEN