

There is more than 1 version of this model.  
Page down to identify the version you have.

■ Order by Part Number

#### FOR MODELS ENDING IN "AC"

Power Connection Extension  
with Strain Relief

**174057**

AC Connection Cable  
(1 per device)

**182538**

AC Transformer  
(up to 8 devices; sold separately)

**104630**

Control Box  
(includes Wall Mounting Hardware (x2))

**182534**

Wall Mounting Hardware (x2)

**182536**

Torx Wrench

**174062**

Battery Housing

**174055**

4" Deck Plate (Optional)

**99557**

8" Deck Plate (Optional)

**99558**

## Illustrated Parts

### M•POWER™

#### Electronic Faucet Transitional Style

#### MODEL

8553/8553AC (non-mixing)  
8554/8554AC (mixing)

#### FINISH

Chrome  
Chrome

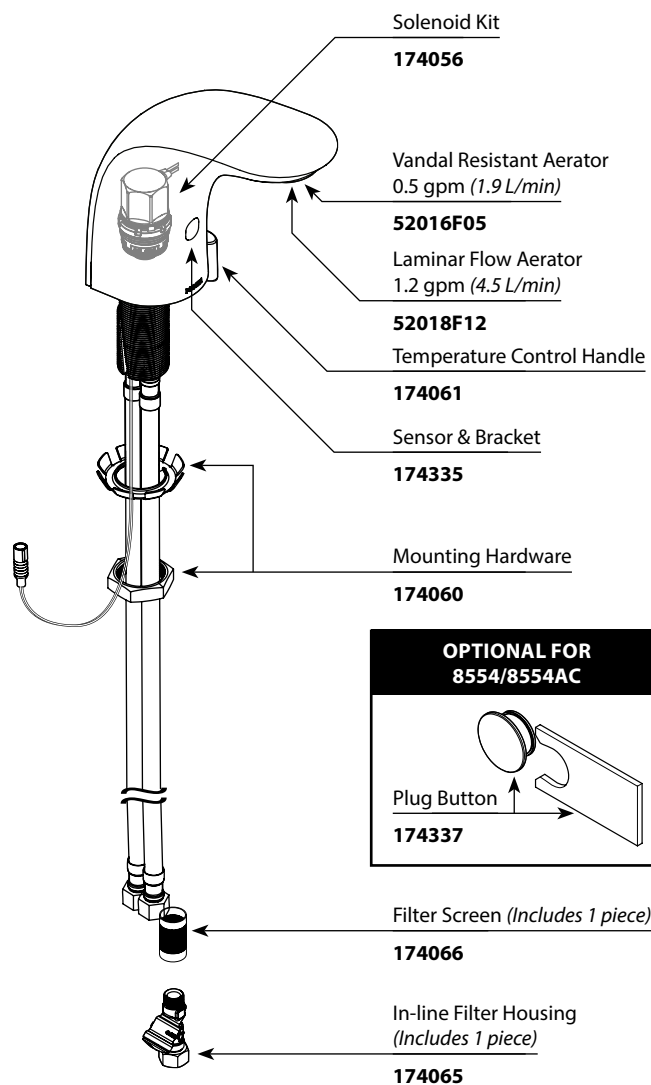

Models prior to November, 2016

■ Order by Part Number

# Illustrated Parts

## M•POWER™

Electronic Faucet Transitional Style

### MODEL

8553/8553AC (non-mixing)  
8554/8554AC (mixing)

### FINISH

Chrome  
Chrome

### FOR MODELS ENDING IN "AC"

Power Connection Extension  
with Strain Relief

174057

Y Cable  
(Pairs with AC Plug-in Adapter 174058)

174059

AC Plug-in Adapter (Discontinued November, 2016)

174058

Torx Wrench

174062

Battery Housing

174055

4" Deck Plate (Optional)

99557

8" Deck Plate (Optional)

99558

Solenoid Kit

174056

Vandal Resistant Aerator  
0.5 gpm (1.9 L/min)

52016F05

Laminar Flow Aerator  
1.5 gpm (5.7 L/min)

52018F15

Temperature Control Handle

174061

Sensor & Bracket

174335

Mounting Hardware

174060

OPTIONAL FOR  
8554/8554AC

Plug Button

174337

Filter Screen (Includes 1 piece)

174066

In-line Filter Housing  
(Includes 1 piece)

174065